

MOTOR KIT FOR INTEGRATED ROLLER SHUTTER - Ø 40mm tube

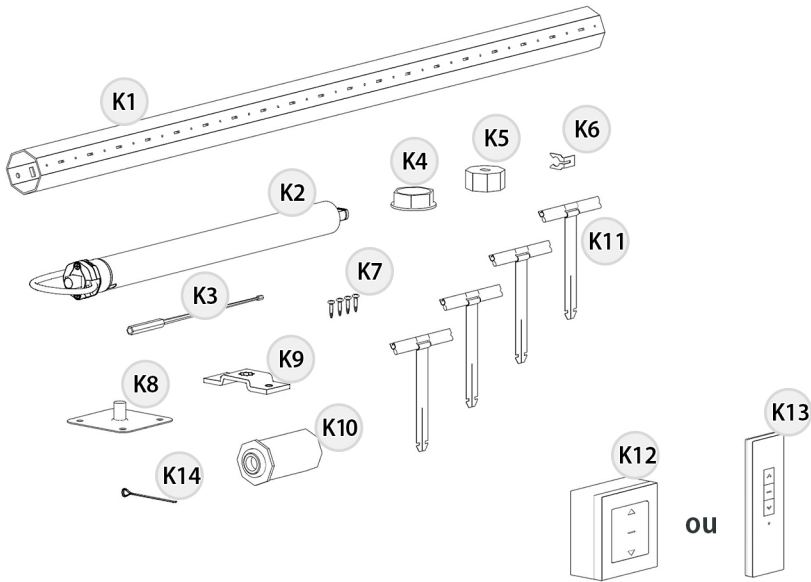

**REMOVAL OF OLD MECHANISM**

It is possible that the tube to be replaced contains a loaded spring. To remove the tube, it will be necessary to relax the spring to avoid any damage or injury.

For step **2**, follow the steps according to your installation:

- Type 1 = my tube has a spring.
- Type 2 = my tube has no spring.

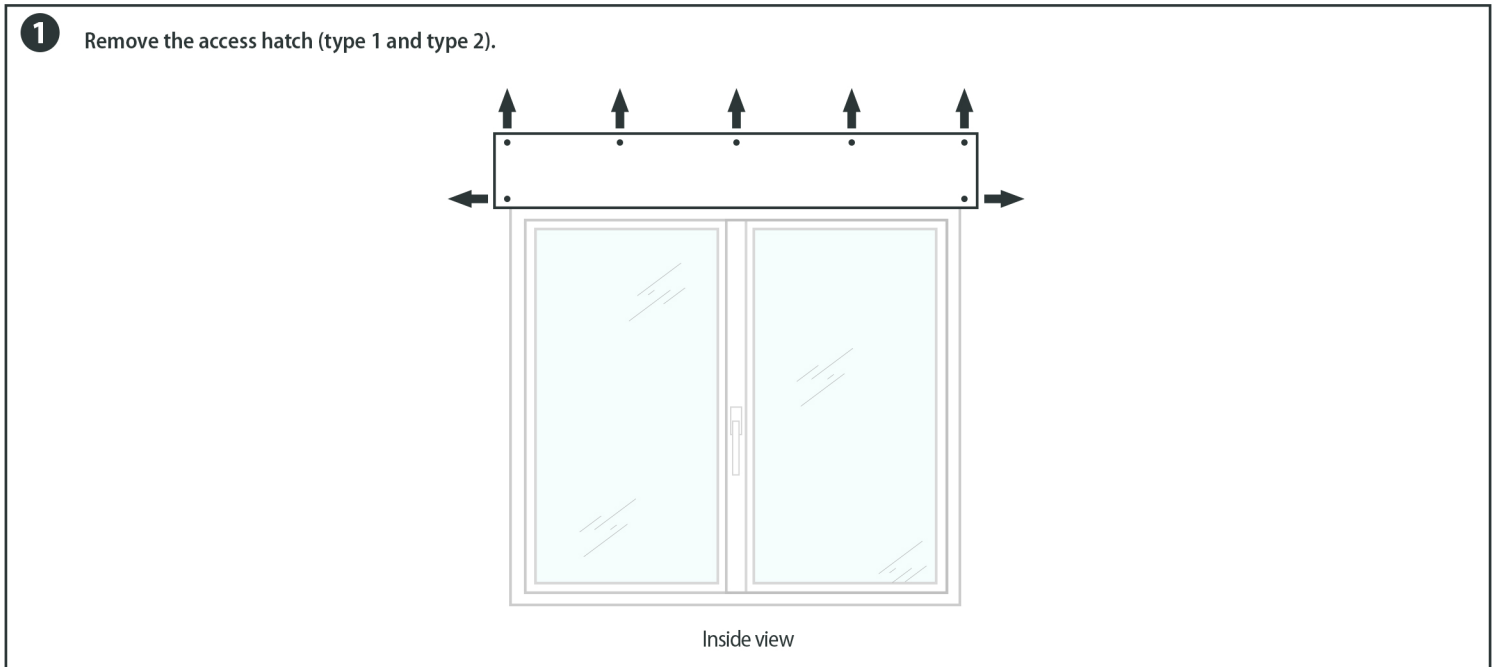

**2** Type 1 :

- A** Mark the position of the tube relative to its support on each side of the tube.

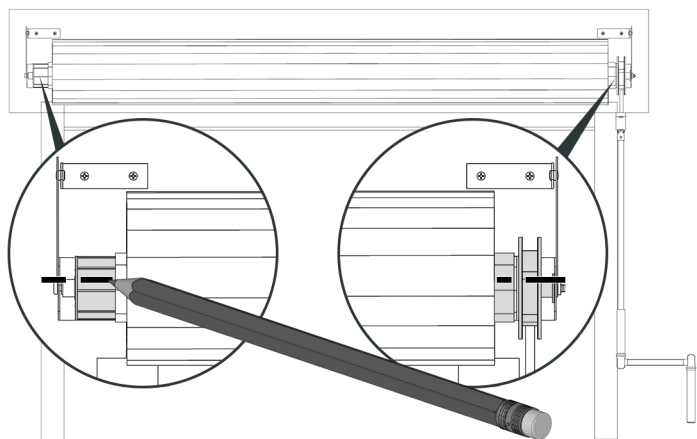

- B** Lower the shutter, counting the number of rotations (using the marks made in the previous step).

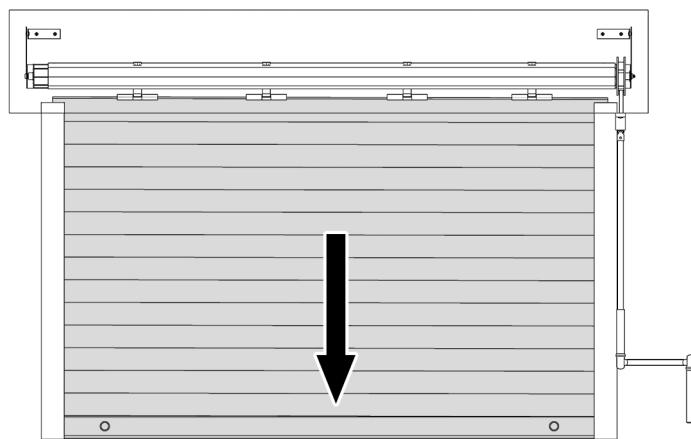

- C** Detach the roller shutter from its tube, taking care to identify the rolling direction of the curtain.

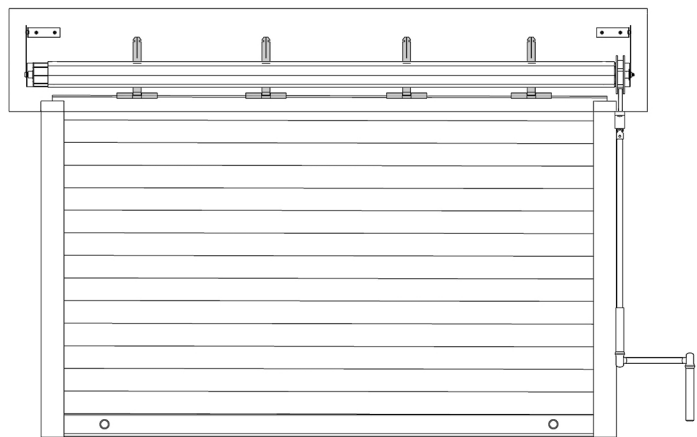

- D** Loosen the spring with the crank: turn the tube the number of rotations marked in step B in the opposite direction (up). Disassemble and remove the crank mechanism.

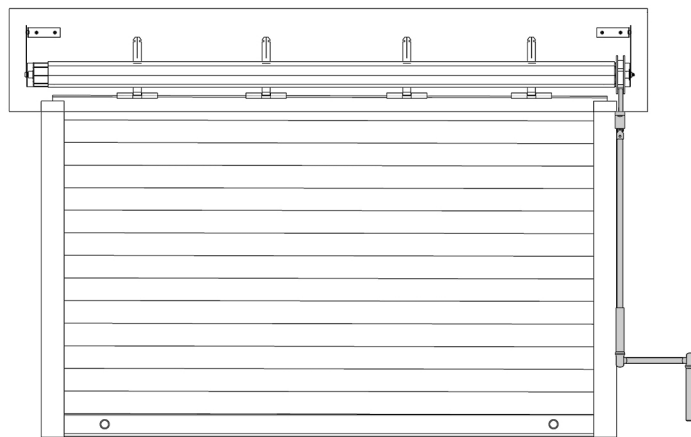

**2** Type 2 :

- A** Lower the roller shutter.

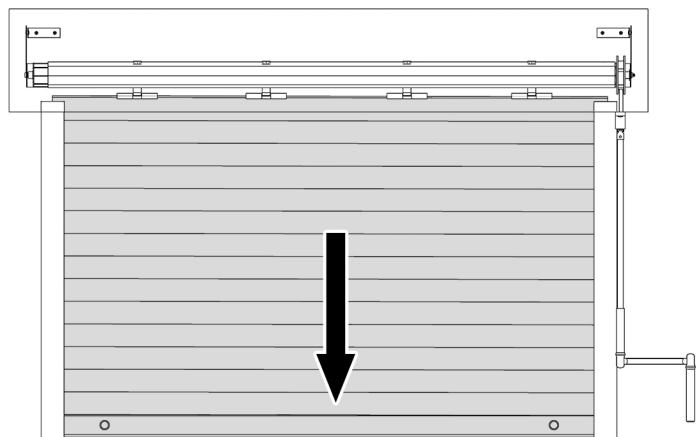

- B** Detach the roller shutter from its tube, taking care to identify the rolling direction of the curtain.

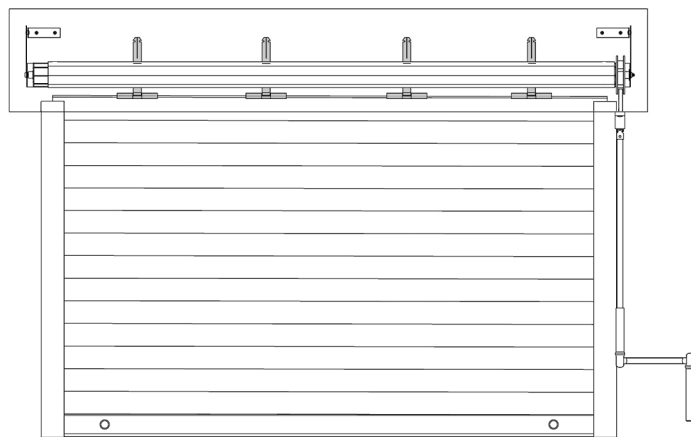

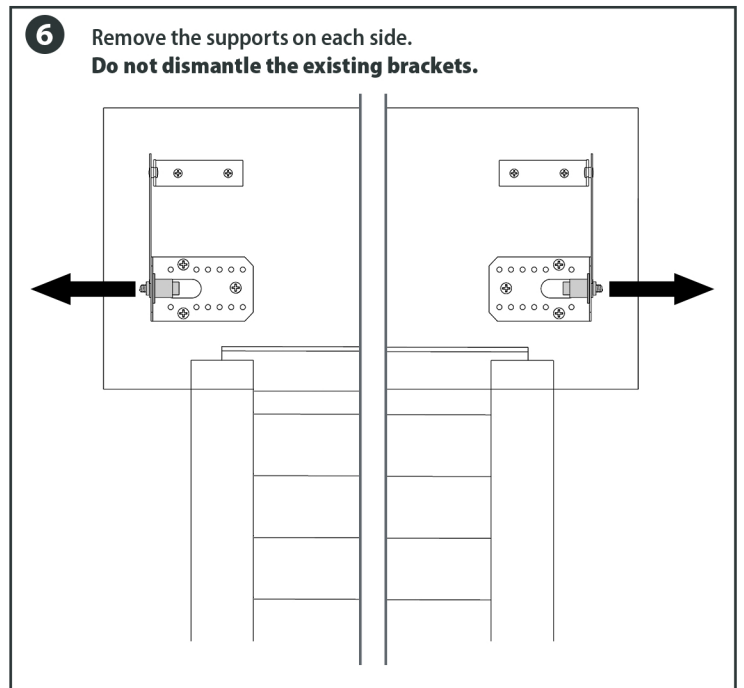
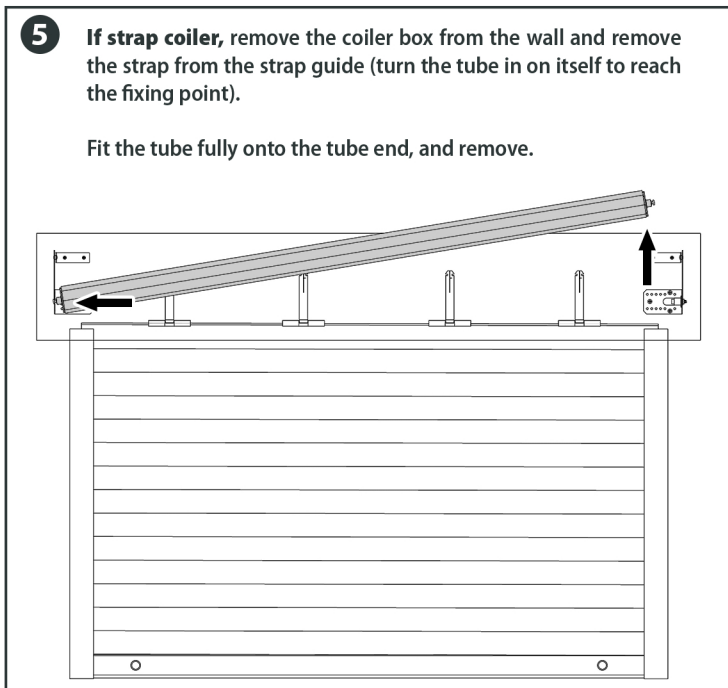
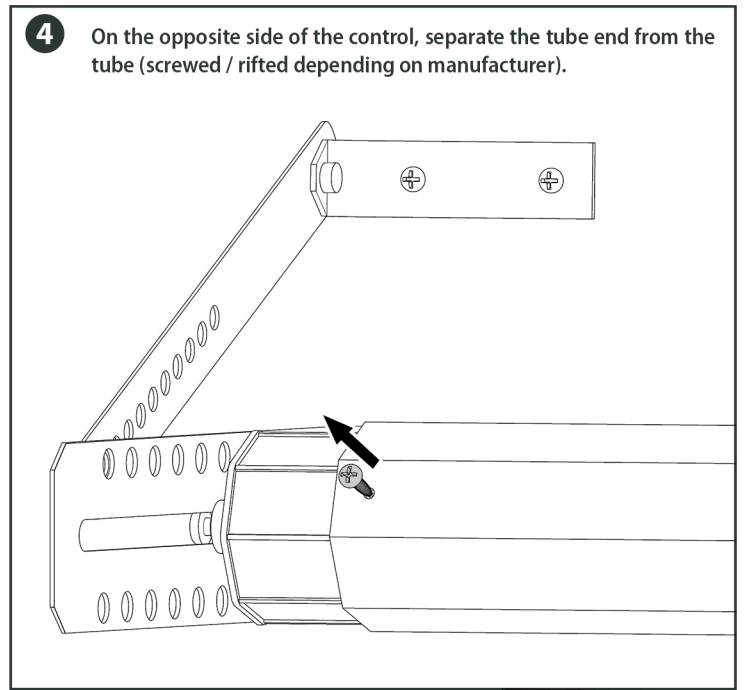
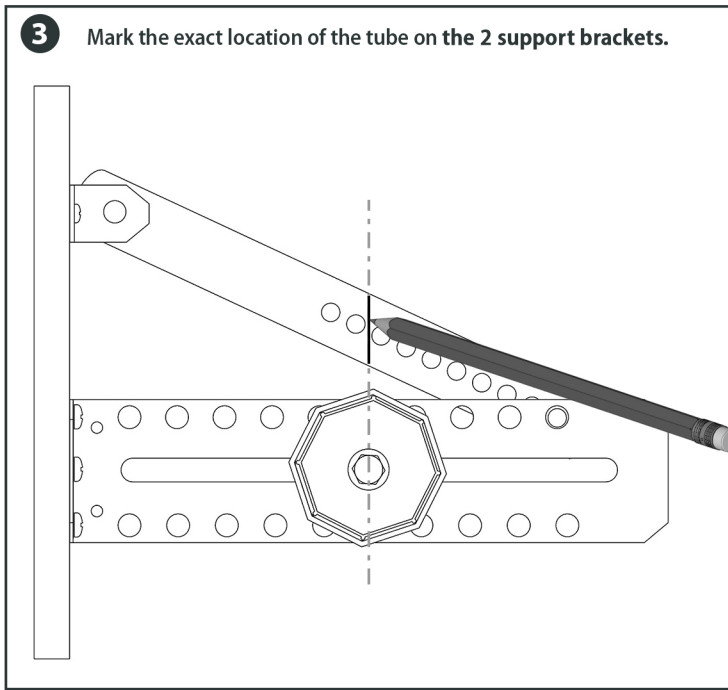

## TUBE DIMENSIONS

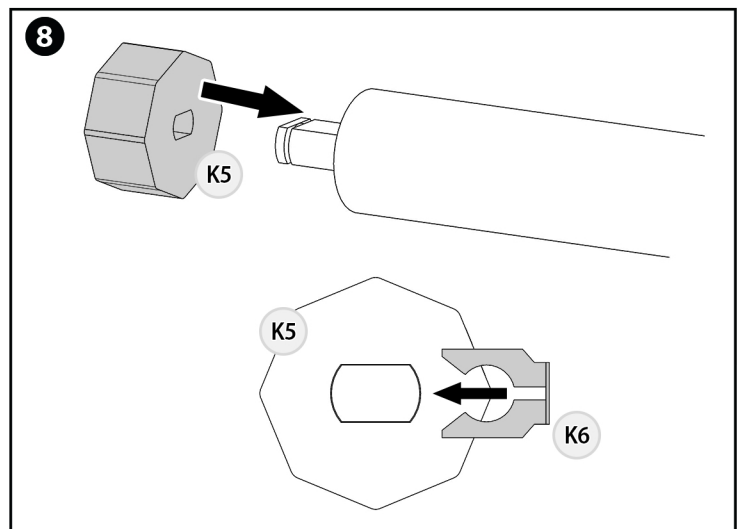
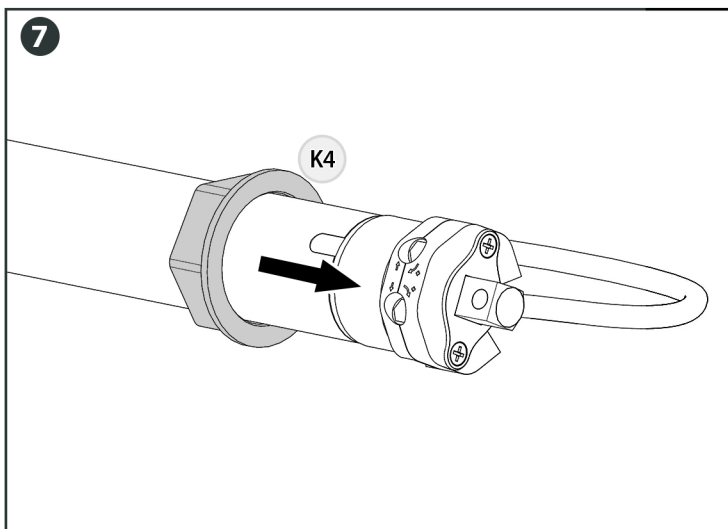

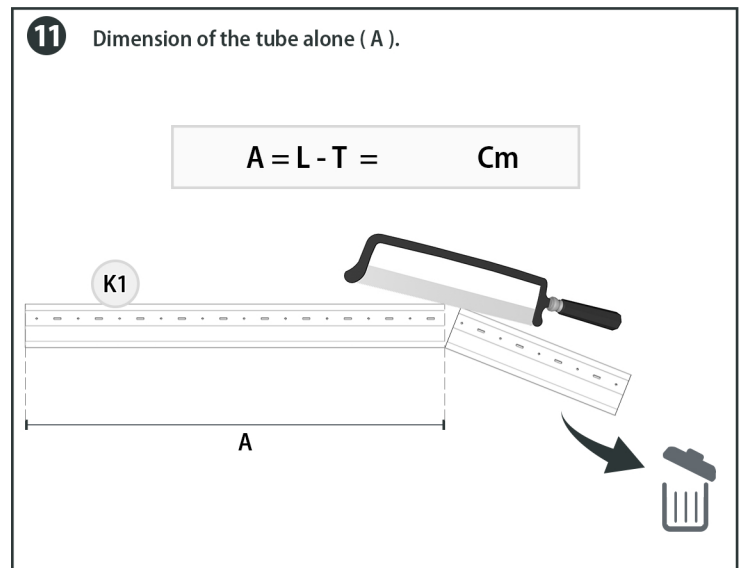
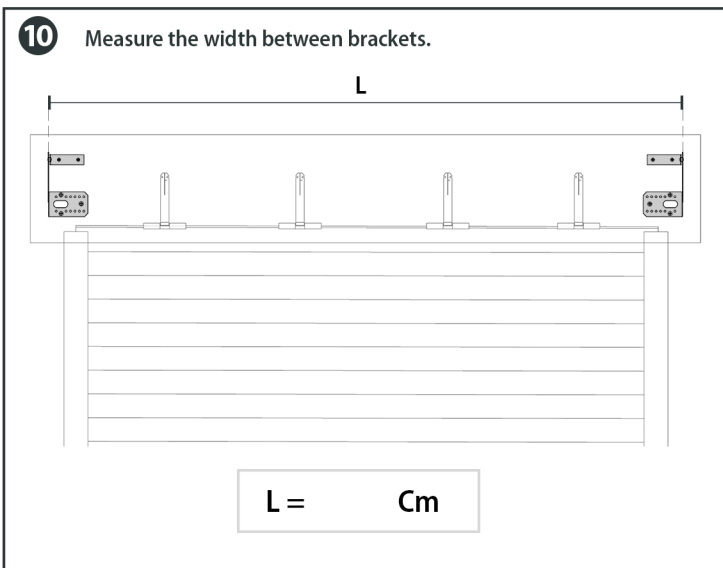
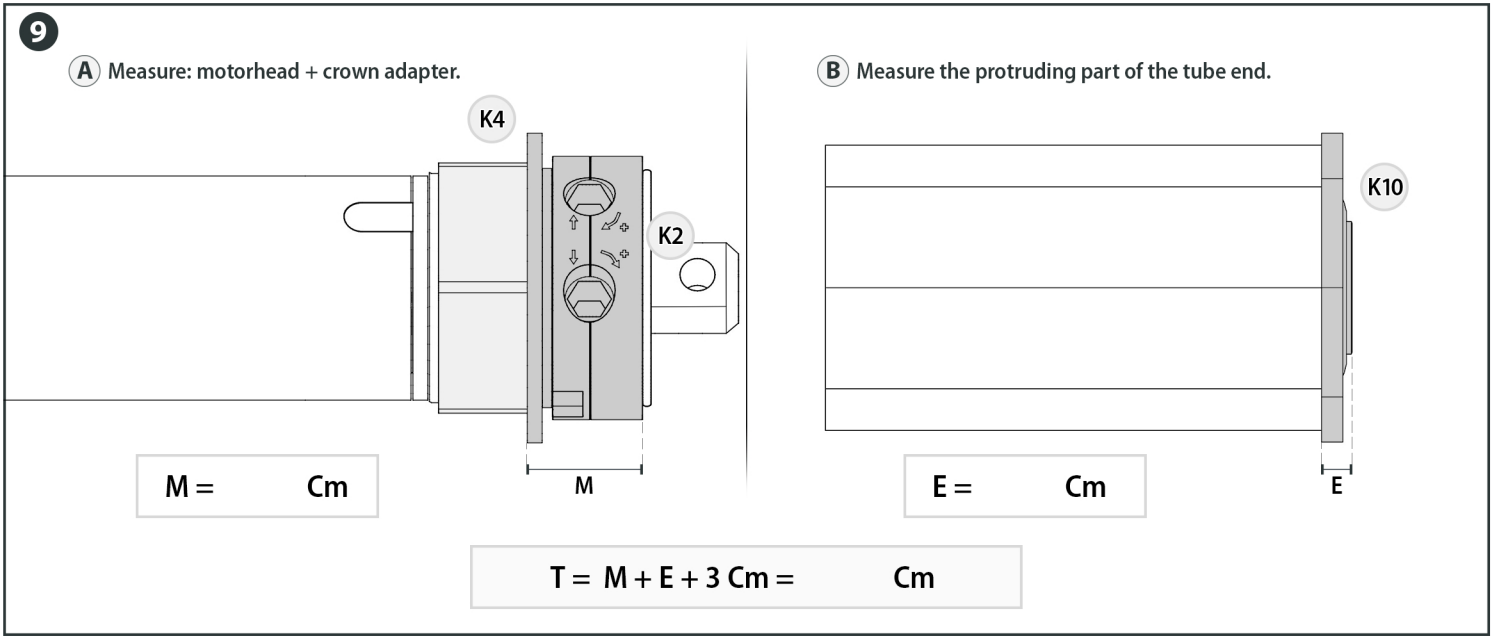

## ASSEMBLY OF THE NEW MOTORISED TUBE

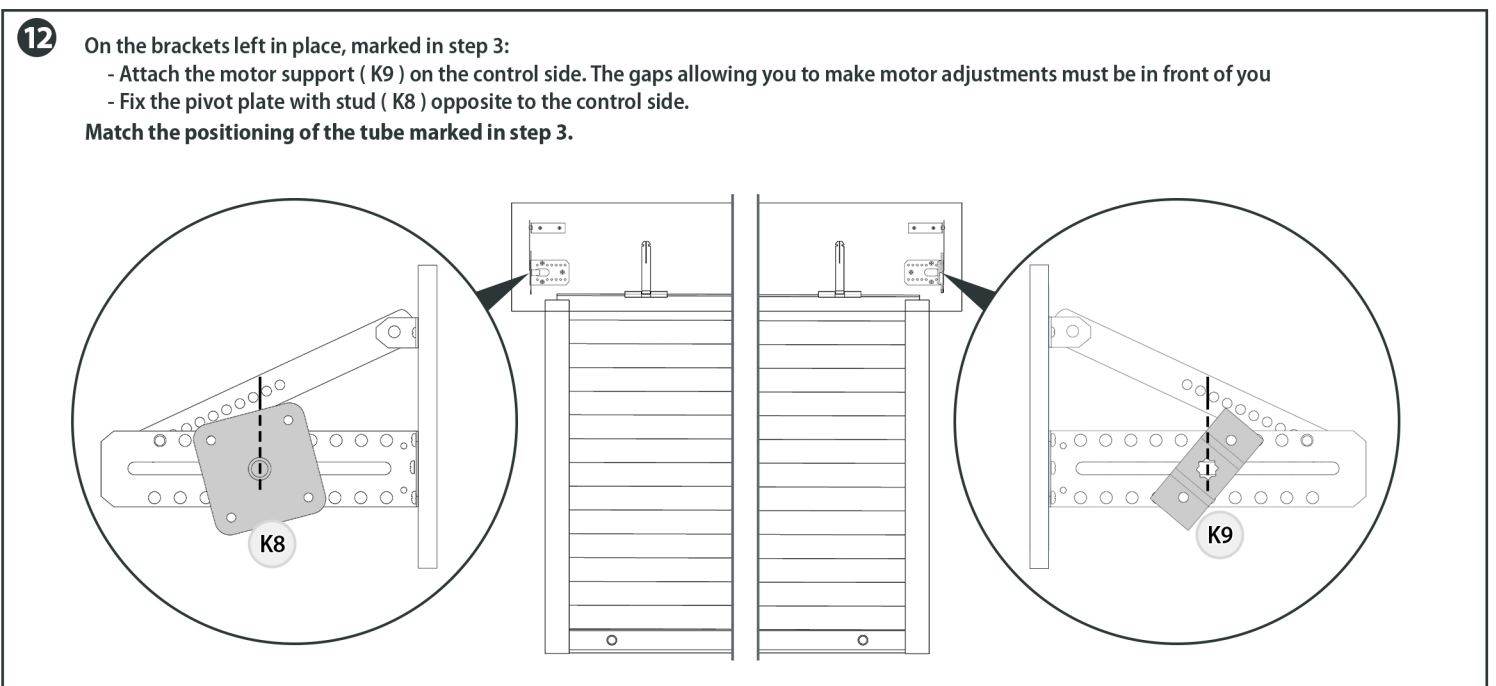

**13** Measure distance P, to secure the motor without damaging it.

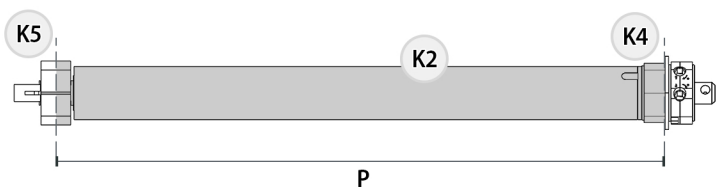

P = Cm

**14** Insert the motor into the tube.  
Mark measurement P on the tube, then screw the tube to the motor wheel (K5) with one of the supplied screws (K7).

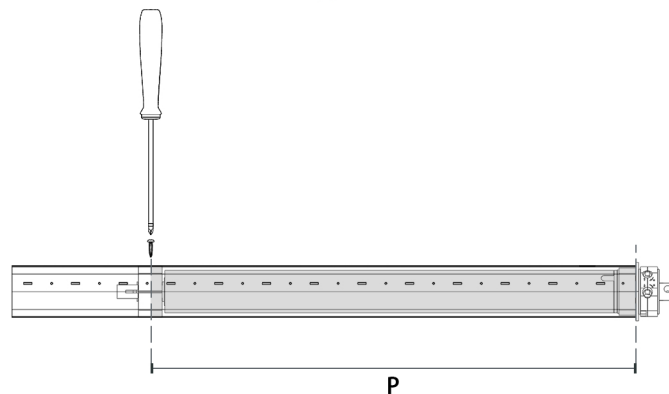

**15** Fit the tube end (K10) on the tube.

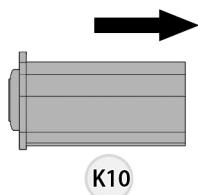

**16** Raise the first slat and attachment clips, then position the tube on its supports.

**Attention :** the motor stop limit adjustment screws must face you.

- Fit the motor head on to the motor support ( K9 ), insert the pin (k14) through the 10mm square. Cross the pin ends to secure it.
- Position the other end of the tube facing the stud plate ( K8 ). Pull the end of the tube to make it lodge onto the stud.

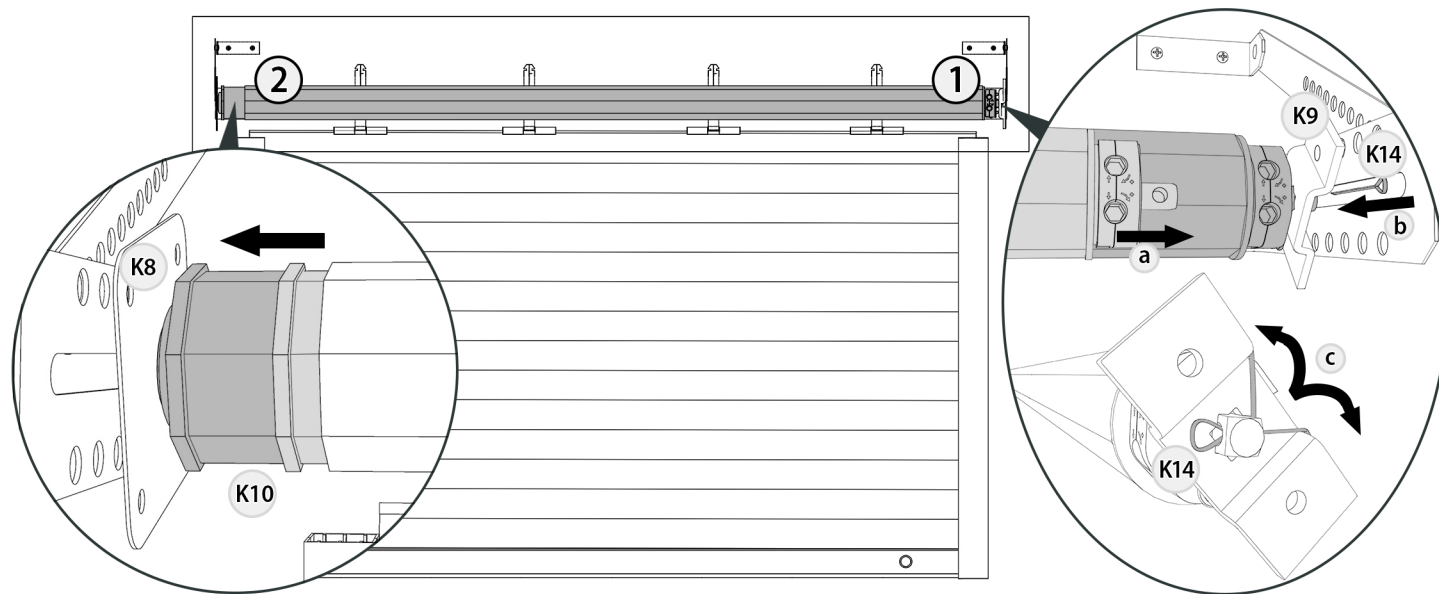

**17** Secure the tube (opposite side to the motor) onto the tube end ( K10 ) with one of the screws provided.

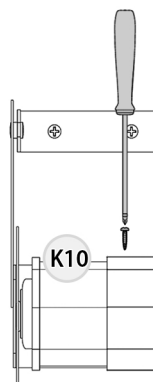

- 20 Reattach the shutter curtain to the tube, paying attention to the rolling direction of the deck (noted in step 2).

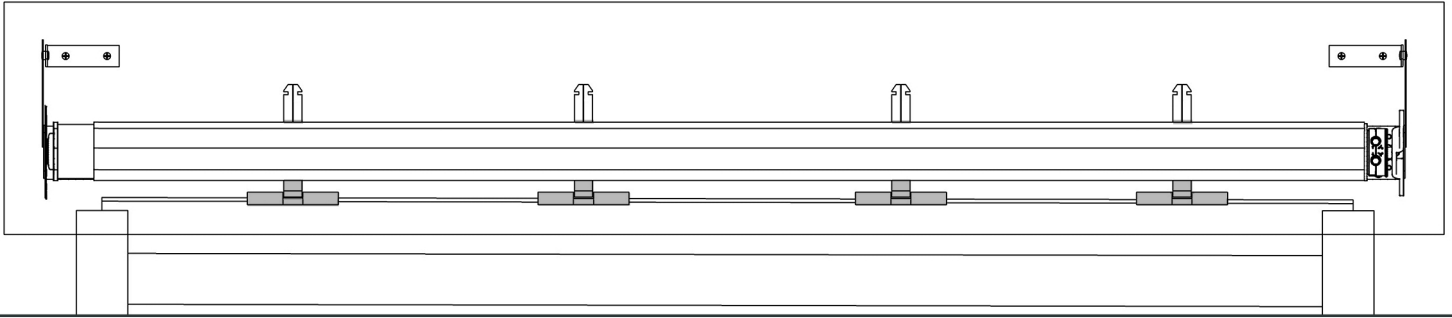

- 21 Make the connections according to the diagram corresponding to your motor. Adjust the upper and lower stops, referring to the instructions for your motor. Then close the access box.

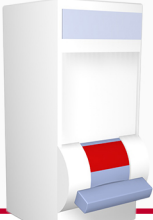

**Before any adjustments...**  
**TURN OFF THE POWER SUPPLY**

**Wired switch motor:**

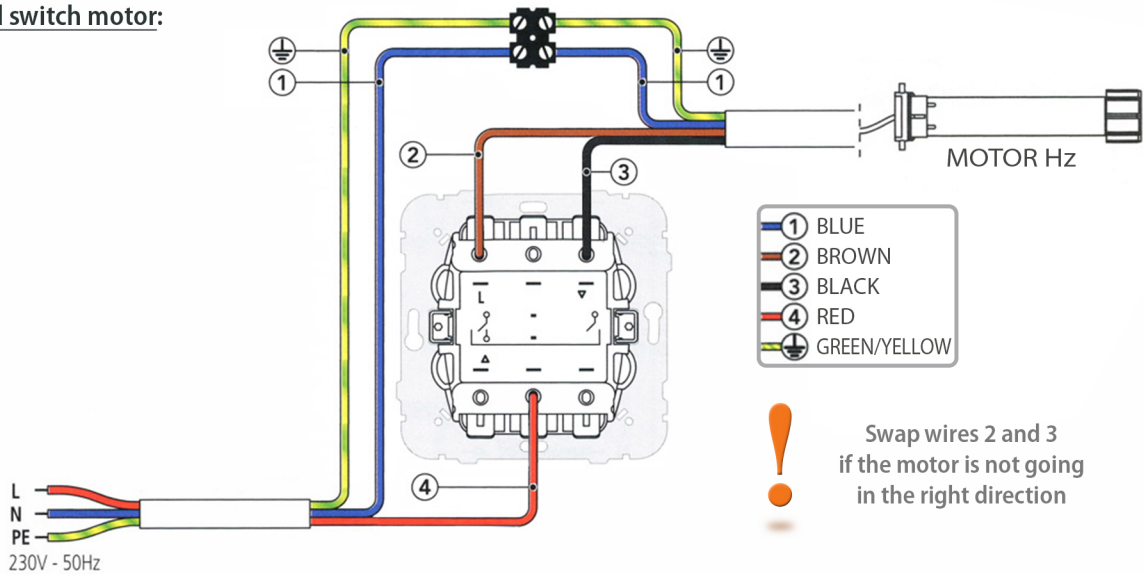

**Wiring 4 wire motors**

Multiple motors on 1 switch: Do not wire more than 2 or more motors in on the same unipolar switch.

**Remote control motor:**

